

B/18/206/116/95
APPROVED
 SUBJECT TO THE CONDITIONS IN THIS OFFICE LETTER.
 No. 21619/95, Date: 25/11/95
 FOR MEMBER SECRETARY
 MADRAS METROPOLITAN
 DEVELOPMENT AUTHORITY
 MADRAS - 600 008.

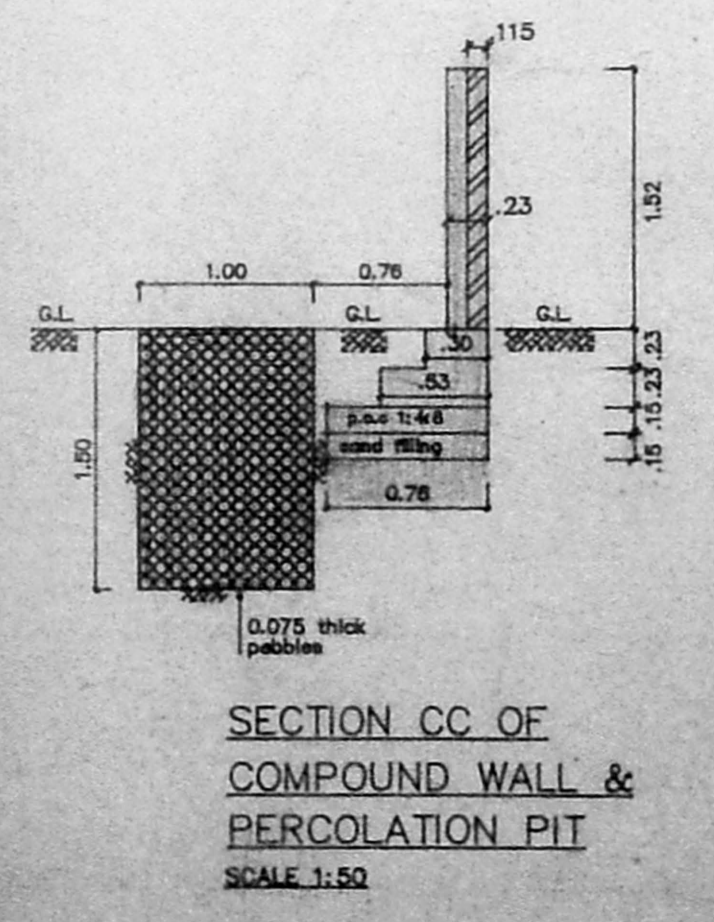
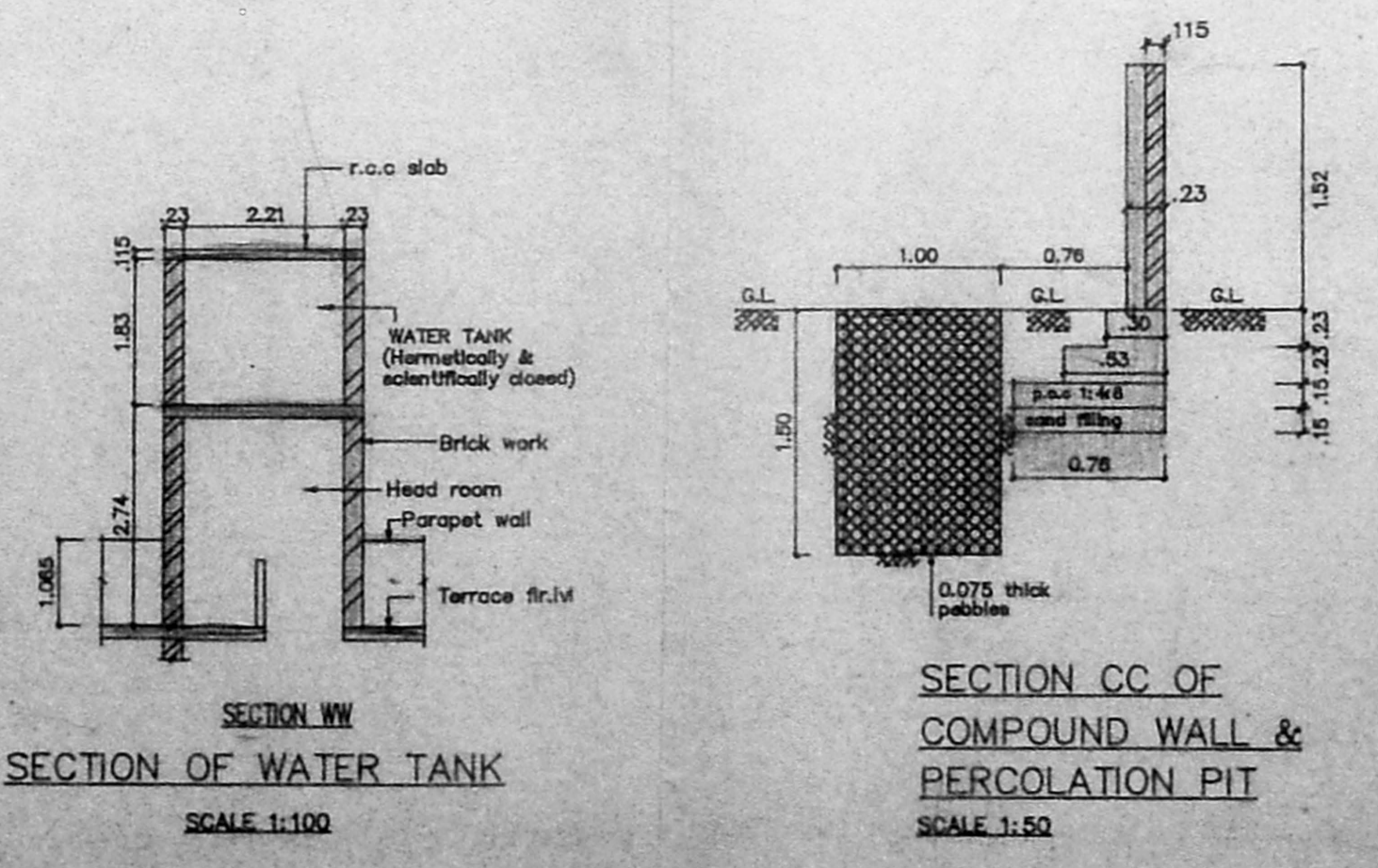
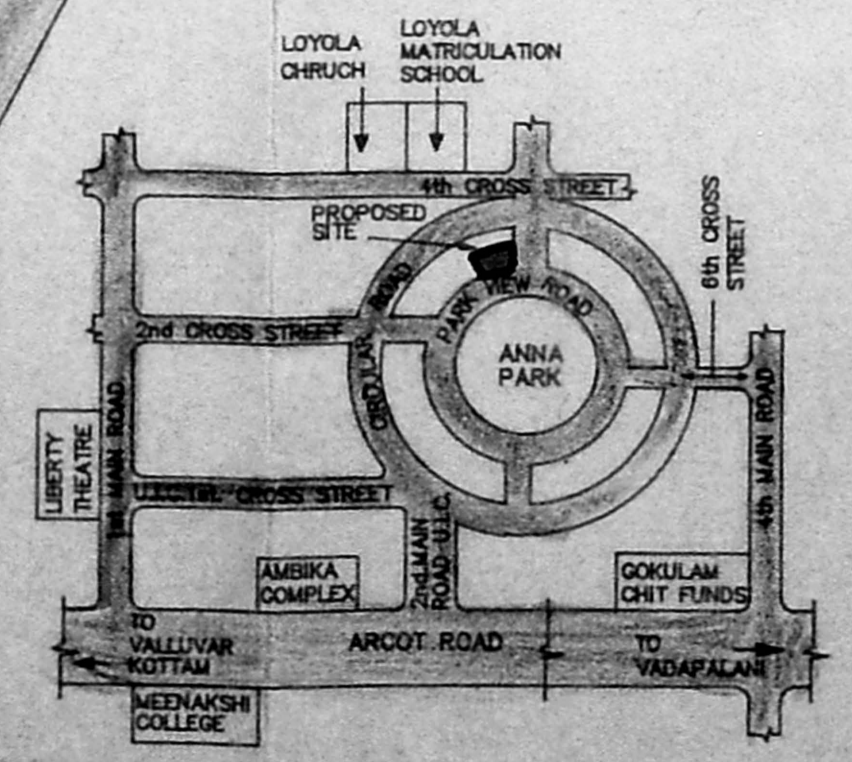
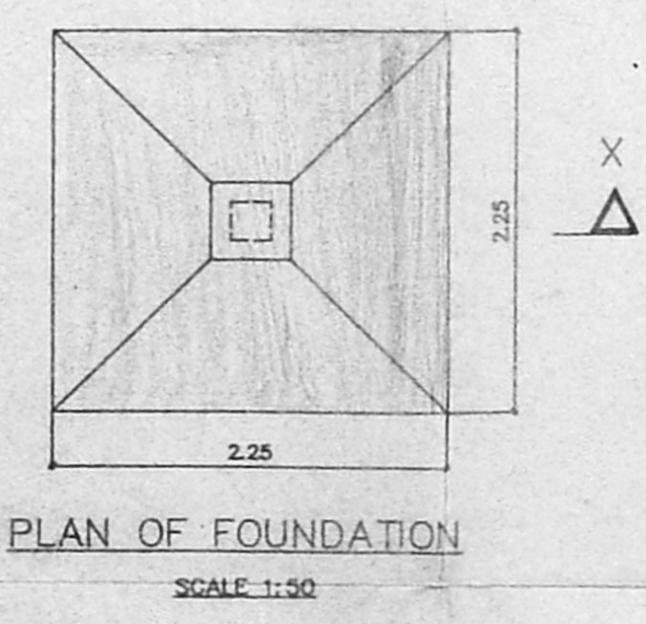
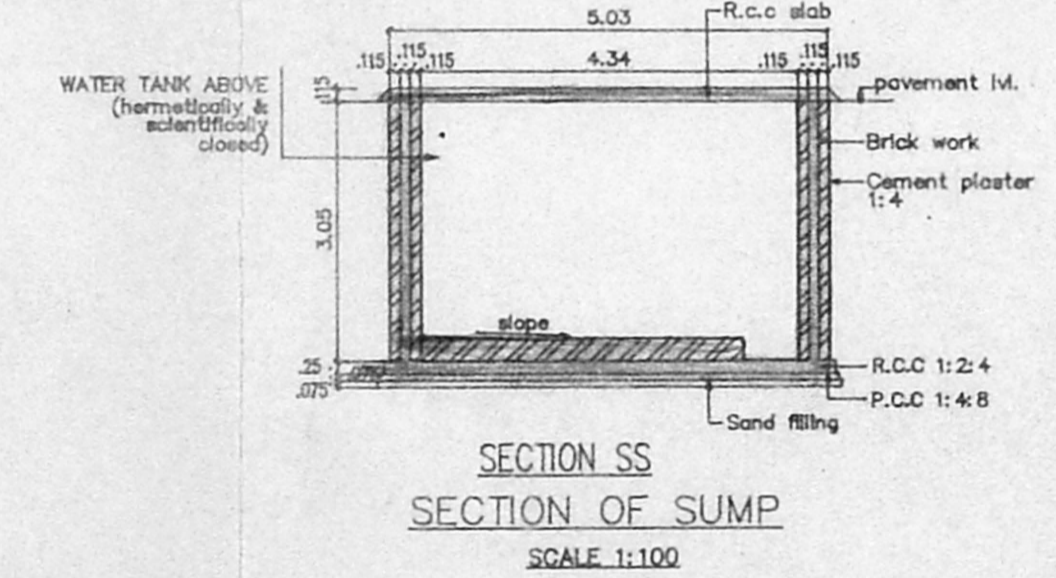
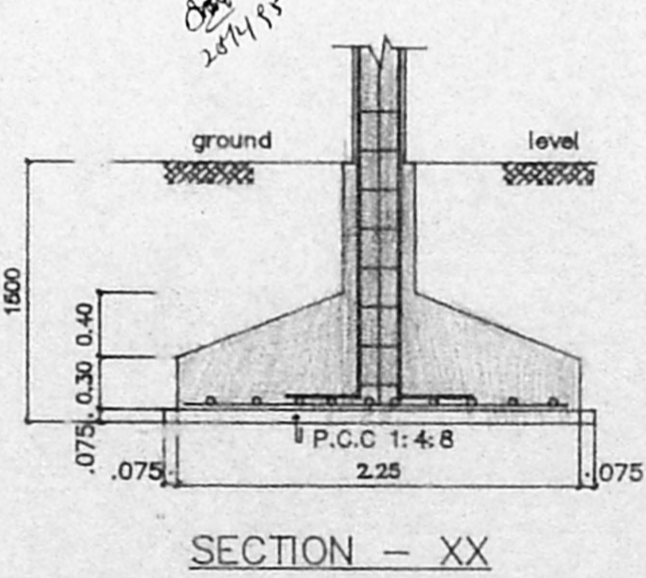

CODE	SIZE	DESCRIPTION
FD1	2.74 x 2.18	COUNTRY WOOD FRAMED FLUSH DOOR
D1	1.00 x 2.18	TEAK WOOD FRAMED FLUSH DOOR
D2	0.91 x 2.18	COUNTRY WOOD FRAMED FLUSH DOOR
D3	0.76 x 2.18	COUNTRY WOOD FRAMED FLUSH DOOR
D4	0.76 x 2.44	COUNTRY WOOD FRAMED FLUSH DOOR WITH VENTILATOR
W1	0.575 x 1.370	STEEL GLAZED WINDOW
W5	1.475 x 0.875	STEEL GLAZED WINDOW
W6	0.975 x 1.37	STEEL GLAZED WINDOW
V1	0.910 x 0.660	STEEL GLAZED VENTILATOR
V2	0.61 x 0.94	STEEL GLAZED VENTILATOR
O	2.21 x 1.37	OPENING

SL.NO	DESCRIPTION
1.	P.C.C. 1:4:8 IN FOUNDATION
2.	SAND FILLING IN FOUNDATION
3.	BRICK WORK IN C.M. 1:6
4.	R.C.C. WORK FOR SLABS, LINTELS & BEAMS Etc.,
5.	PLASTERING IN C.M. 1:5 EXTERNAL & 1:4 INTERNAL
6.	MOSAIC TILED FLOORING.
7.	WEATHERING COURSE OF BRICK JELLY LIME CONC.

AREA STATEMENT	
PLOT AREA	526.11 M ²
BUILT UP AREA	782.1712 M ²
COLOUR INDEX	
PROPOSED CONSTRUCTION	
BOUNDARY OF SITE	
ROAD	

R.No	DATE	REVISIONS	INITIAL

DRG No	DATE	SCALE	REV	FILE	DRN. BY	CHKD.
1 651 174 M	21-06-94	1:100	0	MAITRI	CORSIC174	James

PROPOSED CONSTRUCTION OF FLATS
 AT No : 4, PARK VIEW ROAD,
 UNITED INDIA COLONY,
 KODAMBAKKAM,
 MADRAS - 600 024
 PLOT No : 79,
 T.S. No : 55,
 BLOCK No : 40,
 TALUK : SAIDAPET,
 CORP.DIV. No : 120 (new) 116 (old)
 ZONE No : 8 (new) 7 (old)

P.O.A AGENT

OWNER'S SIGNATURE

LICENSED SURVEYOR
 L.S. No : 306 94/95